

FLEET SHEET

Haldex

Automatic Drain Valve (ADV)

Application Information

1. Install or retrofit to existing air reservoirs.
2. Air tank must have an available 1/4" port for mounting.
3. Fits all makes and models of vehicles.

Competitive Advantages

- ✓ Serviceable Design
Advantage Haldex: Can be serviced in the field eliminating the need for replacement of entire unit.
- ✓ Unique Function
Advantage Haldex: Works independently from the governor, removing oil, water and carbon with each brake application.
- ✓ Doesn't depend upon compressor cycling
Advantage Haldex: Reduces possible build-up of harmful condensation and contaminants.
- ✓ Ensures that liquids are automatically removed
Advantage Haldex: Results in optimal brake systems performance.
- ✓ Built-in Heater
Advantage Haldex: Prevents freeze-ups and keeps air system clean in all temperatures.
- ✓ Compact Low Profile Design
Advantage Haldex: Will mount virtually anywhere a manual drain valve is located — optional 90° fitting provided for horizontal port applications.
- ✓ Sealed Electrical Connection
Advantage Haldex: Prevents corrosion which extends product life.
- ✓ Integrated Filter
Advantage Haldex: Protects valve against contamination for a higher degree of reliability.



Special Notes:

Optional relay switch and 90° fitting are included with each valve.

See reverse side for further details.

FLEET SHEET

cont.

Haldex

Automatic Drain Valve (ADV)

Cross-Reference Information

- Bendix® DV2
- Stemco Automatic Moisture Ejector

Related Items Checklist

- Electrical Connectors
- Tie Wraps
- Pipe Sealant

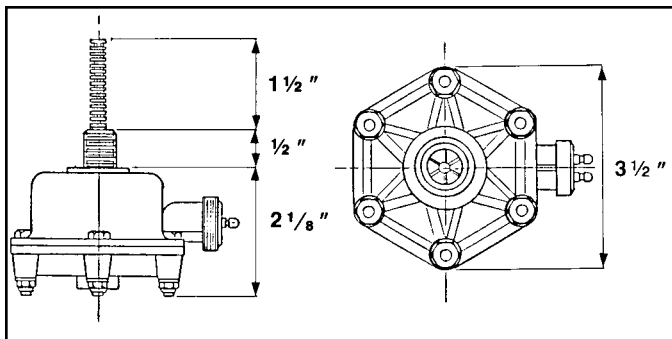

Warranty

One Year/100,000 Miles from date of installation.

Competitor Overview

BENDIX® DV2

- 1) Heater is not standard.
- 2) Unit with heater is over one inch taller.
- 3) No integrated filter.
- 4) Activated by air pressure differential.

Stemco Automatic Moisture Ejector

- 1) Relies on governor air signal to purge - may result in excess moisture accumulation in air reservoirs.

Interchange/Upgrade Programs

Interchange/Upgrade Programs are not applicable to the Haldex Automatic Drain Valve.

Available Literature

Current	Haldex Master Catalog
L20381	Air Treatment Brochure
L20569	Air Treatment Fleet ID Guide
L25058	Automatic Drain Valve Data Sheet

Installation Advisories

- ✓ Vertically mount valve - use provided 90° fitting for horizontal port application.
- ✓ Tighten valve finger tight using provided hex, tighten an additional 1 1/2 turns - do not over tighten.
- ✓ Valve is powered through a separate relay; relay and instructions provided.